

VICTRON ENERGY  
LYNX DISTRIBUTOR  
SHOWN WITH COVER OFF

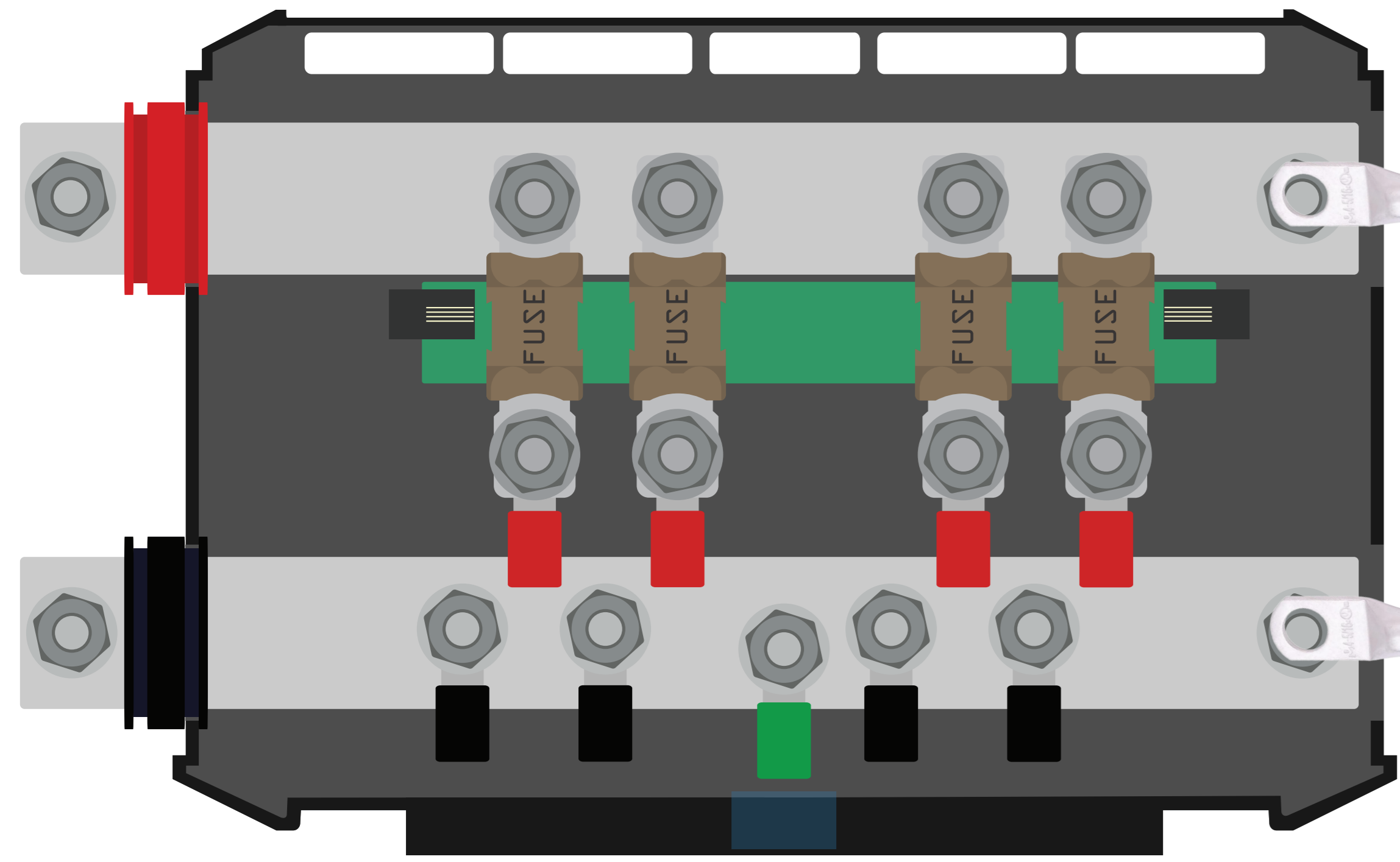

10 AWG, 5/16" LUG

SHORT LENGTH  
<12" 10 AWG WIRE

10 AWG, #10 LUGS

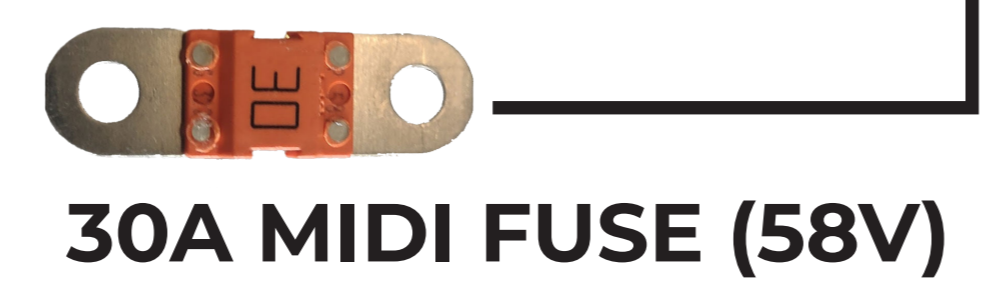

8 AWG, 5/16" LUG

NOMADIC COOLING X2  
ROOFTOP AIR CONDITIONER



DC POWER SUPPLY WIRES FROM BOTTOM OF  
AC UNIT WITH CONNECTORS REMOVED

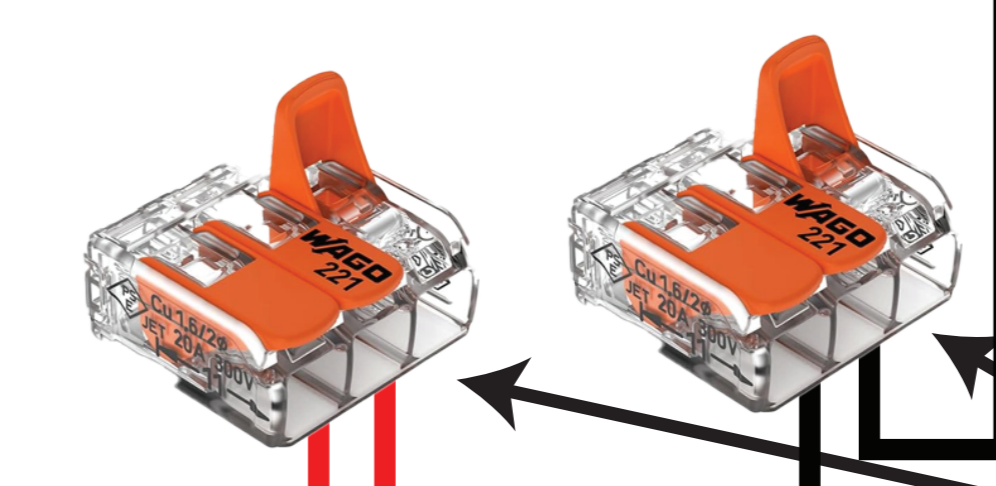

WAGO LEVER LOCK CONNECTORS  
USED TO BRIDGE DC SUPPLY  
TO AIR CONDITIONER. COVER WITH  
INCLUDED HEAT SHRINK AFTER SPLICING.

10 AWG WIRE FROM DC SOURCE  
TO AIR CONDITIONER LOCATION  
25' OF RED AND BLACK DUPLEX WIRE INCLUDED



**REMOVE CONNECTOR**  
THE AC UNIT WILL HAVE  
A SHORT POWER SUPPLY WIRE  
WITH AN "ANDERSON" CONNECTOR  
COMING OUT OF THE BOTTOM OF  
THE UNIT. YOU WILL NEED  
TO REMOVE THIS CONNECTOR  
IN ORDER TO USE THE SPLICERS  
IN OUR KIT.



**VANLIFE**  
OUTFITTERS

**NOMADIC COOLING X2  
BASIC DIY INSTALLATION KIT  
48-VOLT**

*Note: wire gauge included in the kit is based on a relatively short wire run installed into a small vehicle like a van. Please use an ampacity calculator such as the "Blue Sea Circuit Wizard" when sizing your wire for your particular situation.*

